

SINGLE AXLE GARDEN TRAILER
MODEL 5400
OWNER MANUAL



Manufactured by:

Country Manufacturing, Inc.

P.O. Box 104

Fredericktown, OH 43019

PH: 740-694-9926

FAX: 740-694-5088

MODEL 5400 SINGLE AXLE TRAILER

I. INTRODUCTION

The Model 5400 Single Axle Trailer is designed for rugged use and versatility. The sideboards are removable from any side allowing unloading from any of the four sides. By removing the four corner stakes the trailer can be converted into a flatbed.

CAUTION
THIS TRAILER IS NOT FOR OVERHIGHWAY USE.

II. ASSEMBLY INSTRUCTIONS (Refer to Exploded View)

TOOLS REQUIRED

1/2" wrench, 5/8" wrench, Pliers

CHASSIS ASSEMBLY (Refer to FIG. 1)

1. Attach the 2" square tongue (Item 9) to the axle holder (Item 1) using two each 5/16" x 1 1/2" bolts, 5/16" nuts and lock washers. Align the corresponding holes and tighten the nuts as firmly as possible.
2. Install the two wheel assemblies onto the 3/4" axles. Slide a 3/4" washer onto the axle and insert the 1/8" cotter pins.
3. Grease each wheel via the grease fittings located inside the wheel hub.

ATTACHING BED TO CHASSIS

1. While holding bed between uprights on the chassis align the forward set of holes located on the angle iron runners on the bottom side of the bed with the two holes on the uprights of the axle holder. Once aligned, insert the 1/2" rod (Item 8) through the axle holder and bed holes allowing the bed to pivot. Install cotter pin through hole in 1/2" rod.
2. Install the front latch plate (item 14) to the front cross member of the bed (underneath) using two each 5/16" x 1" bolts, 5/16" nuts and lock washers. Tighten bolts firmly.
3. Push front of bed down until the latch plate installed in step 2 is secured by spring loaded release lever. Pulling the lever toward the front should release the bed to its dumping position. If the latching mechanism does not work freely, bending of the latch plate may be required.
4. Install the four bed corner brackets (Item 20 & 21) by removing the four bolts located at each corner of the bed and reinserting through the holes of each corner bracket. Firmly secure using a 5/8" wrench.
5. Install the eight 1" x 6" wood boards by inserting each into the grooves of each corner stake. Install the two middle angle iron stakes into the pockets located on the side rail of the while hooking the top over the sideboard.

III. MAINTENANCE AND OPERATION INSTRUCTIONS.

1. To perform a dumping operation, simply pull forward on the spring-loaded latch located on the tongue.

CAUTION
STAY CLEAR OF THE BED WHEN RELEASING THE LATCH FOR DUMPING

2. Unloading can be accomplished from any side of the trailer by removing the desired sideboard.
3. Periodically grease each of the two wheels via the fitting located on the inside of the hub.

**MODEL 5400 SINGLE AXLE TRAILER
EXPLODED VIEW**

FIG. 1

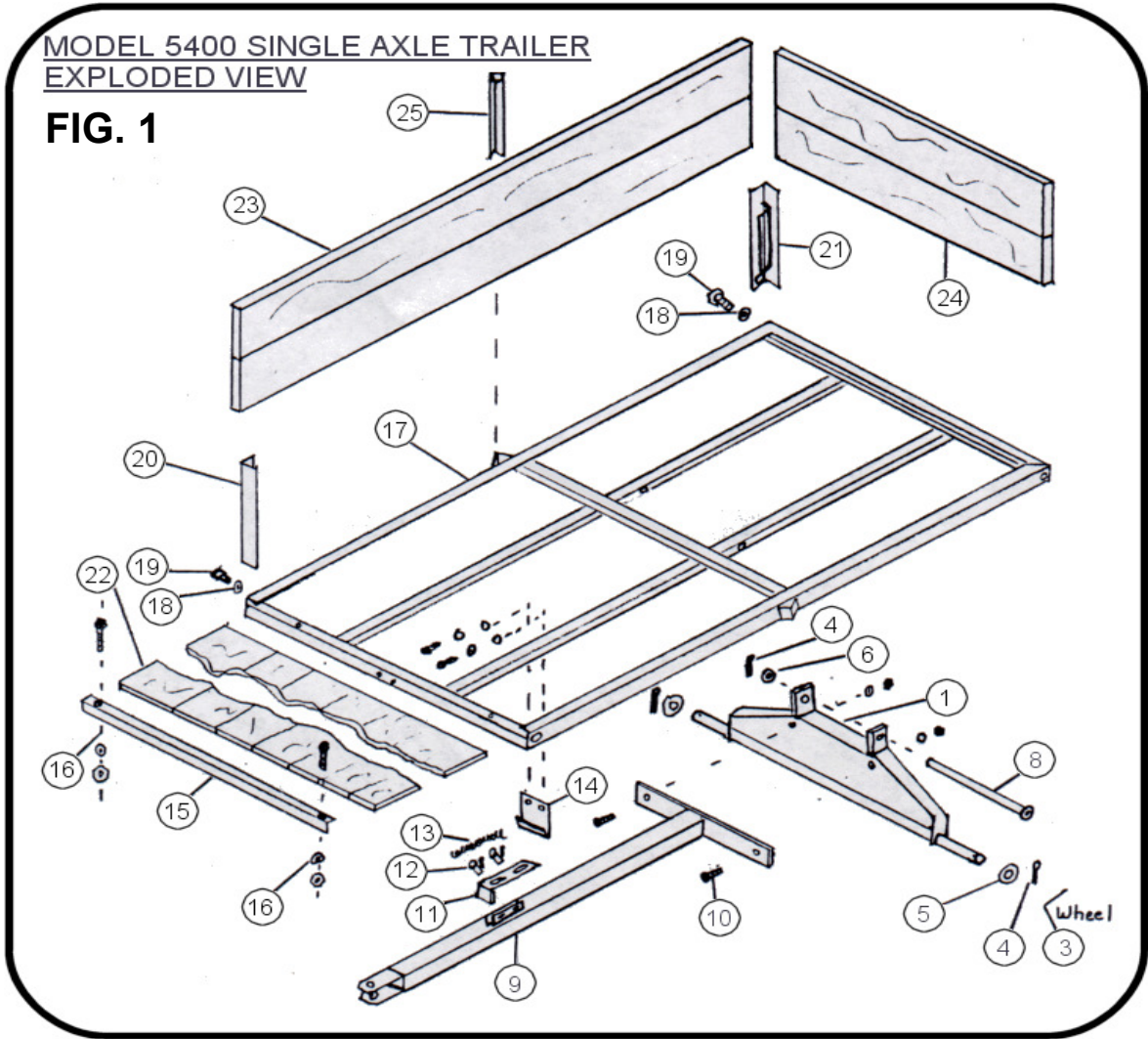

ITEM NO	DESCRIPTION	PART NO	QTY/UNIT
1	Axle Support	5400-1	1
3	16-6.50 x 8 Wheel & Tire	5400-3	2
4	1/8 Cotter Key	5400-4	3
5	3/4 inch Flat Washer	5400-5	2
6	1/2 inch Flat Washer	5400-6	1
8	1/2 inch Pivot Rod	5400-8	1
9	Tongue Assembly	5400-9	1
10	5/16 x 1 1/2 Grade 5 bolt/nut/washer	5400-10	
11	Dump Lever	5400-11	1
12	3/8 Clevis Pin	5400-12	2
13	Dump Spring	5400-13	1
14	Dump Catch	5400-14	1
15	Front Bed Rail	5400-15	1
16	5/16 x 1 1/2 bolt/nut/washer	5400-16	2
17	5 ft. Bed Frame	5400-17	1
18	7/16 Flat Washer	5400-18	4
19	7/16 x 3/4 Bolt	5400-19	4
20	Right Hand Corner Stake	5400-20	2
21	Left Hand Corner Stake	5400-21	2
22	5 ft. Floor Boards	5400-22	7
23	5 ft. Side Boards	5400-23	4
24	End Boards	5400-24	4
25	Center Support Stake	5400-25	2

WARRANTY POLICY

Country Manufacturing, Inc., will, at its option, replace or repair, without charge to the original purchaser any part or parts manufactured by it and found upon examination, to be DEFECTIVE IN MATERIAL AND/OR WORKMANSHIP if received for such examination within 90 days from date of original purchase.

Damage resulting from accident, abuse or neglect are conditions under which warranty cannot be claimed. Nor will warranty apply to damage resulting from failure to follow the Manufacturer's instruction for operation and maintenance nor from the improper selection of a particular application.

All transportation charges on, and damages and loss incurred in connection with the transportation of, parts submitted for replacement or repair under this WARRANTY shall be borne by the purchaser.

No other warranties, guarantees, or liabilities, either implied or expressed, will be the responsibility of Country Manufacturing, Inc.