

3048HKD-ATV  
REPAIR PART LIST

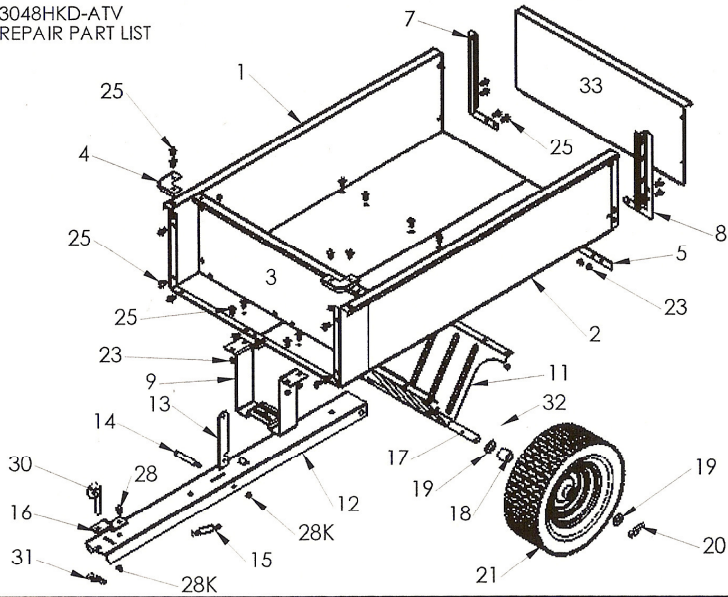

12 ft Heaped Capacity Economy Cart  
os12ftecon cart

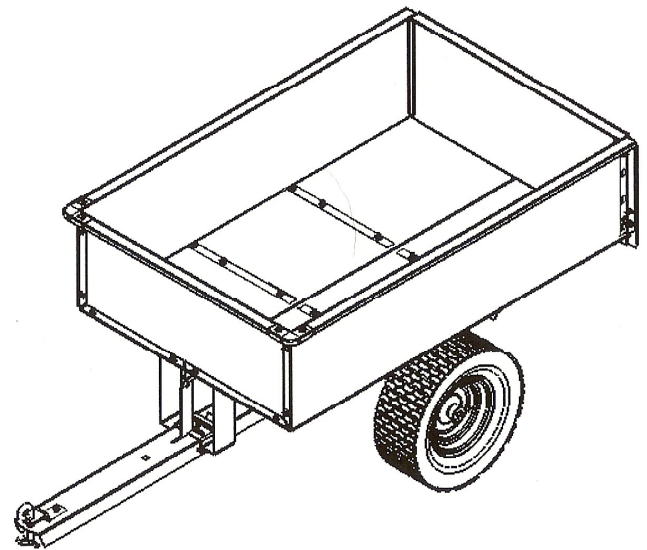

REF. NO.	PART NO.	QTY.	DESCRIPTION	REF. NO.	PART NO.	QTY.	DESCRIPTION
1	5-1	1	Body half - Right	17	5-17ATV	1	Axle
2	5-1	1	Body half - Left	18	5-18ATV	2	HDPE spacer
3	5-3	1	Front gate	19	5-19	4	Axle washer
4	5-4	2	Corner	21	5-21ATV	2	Wheel ATV
5	5-5	1	Rear support bar	23	5-23N	46	5/16"-18 keps nut
7	5-7A	1	Gate retainer - Right	25	5-25	46	5/16"-18 x 3/4" pan head
8	5-8A	1	Gate retainer - Left	28	5-28	1	3/8"-16 x 3/4" hex head
10	5-9A	1	Front Support	28K	5-28K	2	3/8"-16 keps nut
11	5-11	1	Axle Holder	30	5-30	1	Hitch pin
12	5-12A	1	Drawbar	31	5-31	1	Hair pin cotter
13	5-13A	1	Latch post bar	32	5-32	2	Cotter pin
14	5-14A	1	Latch bolt	33	5-33	1	Tail gate
15	5-15A	1	Latch spring	34	5-34ATV	1	Assembly manual
16	5-16A	1	Hitch bracket				

CAUTION:  
READ AND FOLLOW  
ALL SAFETY RULES  
AND INSTRUCTIONS  
BEFORE USING  
THIS EQUIPMENT

Distributed By:  
**Country Manufacturing Inc.**  
[www.countrymanufacturing.com](http://www.countrymanufacturing.com)  
**1-800-335-1880**

3048HKD-ATV - REV B 1/04

**TOOLS REQUIRED**

Large blade screwdriver.  
1/2" wrench and/or socket.  
Pliers.

**SAFETY INSTRUCTION**

Do not carry passengers in cart.  
Do not tow cart on public roads.  
Never exceed load capacity of 1,000lbs.  
Avoid sudden turns or maneuvers.  
When operating on slopes, use lowest ground speed and limit load to 200 lbs.  
Operate up and down slopes, never across the face.

**MAINTENANCE**

Check tire pressure regularly.  
Periodically check all bolts.  
Keep cart clean to prevent rust.  
Store inside a clean dry area.

CARTON CONTENTS		
REF. NO.	QTY.	DESCRIPTION
1	1	Body half - Right
2	1	Body half - Left
3	1	Front gate
4	2	Corner
5	1	Rear support bar
7	1	Tail gate retainer - Right
8	1	Tail gate retainer - Left
9	1	Front support
11	1	Axle holder
12	1	Drawbar assembly
17	1	Axle #9
21	2	ATV wheel
33	1	Tail gate
34	1	Assembly manual
BB	1	Hardware bag

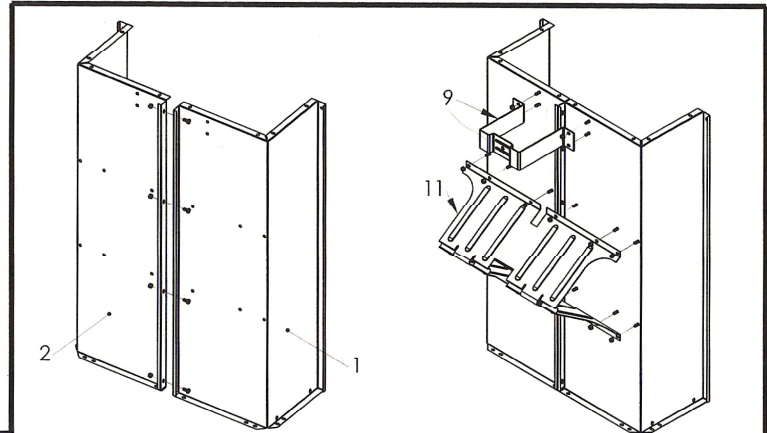

Loosely assemble body halves as shown.

Loosely attach front support and axle holder.

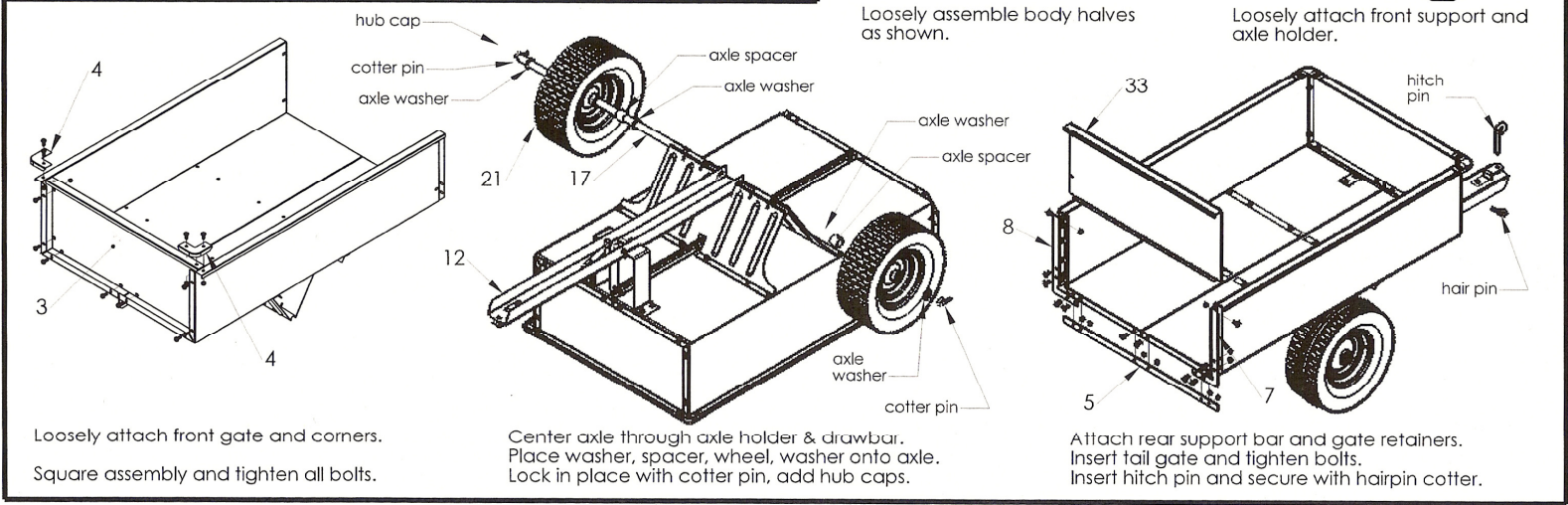

Loosely attach front gate and corners.  
Square assembly and tighten all bolts.

Center axle through axle holder & drawbar.  
Place washer, spacer, wheel, washer onto axle.  
Lock in place with cotter pin, add hub caps.

Attach rear support bar and gate retainers.  
Insert tail gate and tighten bolts.  
Insert hitch pin and secure with hairpin cotter.